

POLYPROPYLENE CASEWORK



WHY SELECT POLYPROPYLENE CASEWORK?

Polypropylene is known for its durability to withstand harsh chemical exposure, corrosion, and for solvent and impact-resistance. The investment in polypropylene can provide a greater value long term when compared to the replacement cost of metal or wood equivalents which could rust and corrode. Polypropylene is ideal for laboratories, requiring no exposed metals or low electrical conductivity.

LabAire Systems works with architects, laboratory planners, principal investigators, and purchasing departments on any size project. Our line of modular casework is designed for maximum chemical resistance with hinges, fasteners and adjusting hardware that are all fabricated from polypropylene.

Select from a wide range of cost-effective fixed or mobile components in standard sizes and add custom-sized designed modules where required.

WHERE YOU CAN FIND LAS PRODUCTS

Wet labs
Chemistry labs
Acid digestion labs
Trace metal labs
Soil science and natural resource
Environmental testing
Oceanic studies laboratories

Educational laboratories
Wastewater treatment labs
Petrochemical labs
Pathology labs
Forensics labs
ICP labs
Sterile Compounding

STANDARD FEATURES OF POLYPROPYLENE CASEWORK

MATERIAL: 1/2" thick, 100% stress-relieved virgin, white polypropylene.

CONSTRUCTION (A): Fully welded cabinet and drawer construction, sealed to contain spills.

HINGES & CLOSURE: Single-piece, polypropylene 5 knuckle hinges and fully-recessed magnetic closures.

DRAWERS (B): Single piece, polypropylene drawers with low-friction UHMW drawer guides.

UPPER CABINET: 12" deep by 24" or 30" tall, with polycarbonate windows or solid doors.

PULLS: Polypropylene pull handle.

SINK CABINETS: Removable plumbing access panel.

BASE CABINETS: 22" deep by 29"(sitting) or 35"(standing) not including countertop.

SHELVES: 1" spill containment provided on all shelves.

ADA-COMPLIANT: Most cabinets available 33" height.

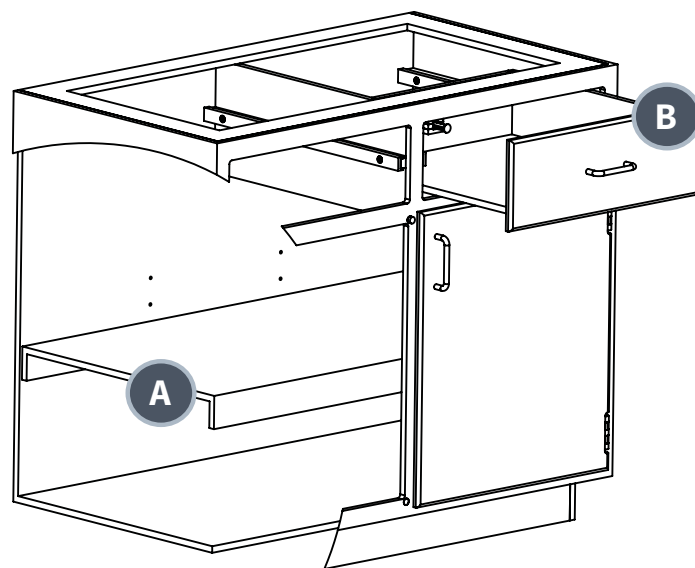

Polypropylene drawers with UHMW drawer guides



Magnetic Latch



Single piece, polypropylene hinges and fasteners

OPTIONAL FEATURES

MATERIAL: Black or natural polypropylene, flame-retardant polypropylene (UL94V or FM4910), PVC, PVDF, and other thermoplastics

WINDOWS: PVC & Clear Polycarbonate.

SLIDING DOORS: Standard handle only.

HARDWARE: Non-ferrous, recessed flush handles, locks, adjustable legs, locking or leveling casters.

DRAWERS: File drawer, specialty dividers, self-closing.

SHELVES: Open shelves and/or storage.

COUNTERTOPS: Epoxy, polypropylene, HDPE

SINKS: Polypropylene or epoxy.

UTILITIES: GFCI outlets, faucets, turrets (deck or wall-mounted), and N2/DI Spray Guns.

OTHER CASEWORK AND ACCESSORIES

Tables and Carts
Drying Racks
Fume Hoods
Umbilical Enclosures

Reagent Racks
Storage Cabinets
Vented Acid Storage Cabinets



Casework Table of Contents

Base Cabinets with Drawers

LAS-100 Basic (3) Drawer Base Cabinet.....	3
LAS-200 Basic (4) Drawer Base Cabinet	3
LAS-300 Basic (5) Drawer Base Cabinet	3
LAS-210 Combination (5) Drawer Base Cabinet	3
LAS-220 Combination (6) Drawer Base Cabinet	4
LAS-230 Combination (7) Drawer Base Cabinet.....	4
LAS-240 Side By Side (8 Drawer) Drawer Base Cabinet	4
LAS-330 Combination (8) Drawer Base Cabinet	4
LAS-340 Combination (9) Drawer Base Cabinet	5
LAS-350 Side By Side (10 Drawer) Base Cabinet	5

Base Cabinets with Drawers & Shelving

LAS-400(L/R) Hinged Solid Single Left/Right — Door/Drawer Base Cabinet.....	3
LAS-405 Hinged Solid Double Door With Single Drawer Base Cabinet	3
LAS-410 Hinged Solid Double Door With (2) Drawer Base Cabinet	3
LAS-401(L/R) Hinged Single Left/Right Door/ (3) Drawer Base Cabinet	4
LAS-402(L/R) Hinged Single Left/Right Door/ (4) Drawer Base Cabinet	4
LAS-500(L/R) Left/Right Hinged Full Door Base Cabinet With Shelf.....	3

Base Cabinets with Shelving

LAS-510 Hinged Double Door Base Cabinet With Shelf	3
LAS-510S Hinged Double Door Sink Cabinet No Shelf	3
LAS-510V Vented Acid Storage Double Door Base Cabinet With Shelf	3
LAS-511S ADA Open Sink Cabinet With Angle Board	4
LAS-500(L/R) Left/Right Solid Single Door 5 Foot Tall Cabinet	4
LAS-500(L/R) Left/Right Solid Single Door 7 Foot Tall Cabinet	4

Base Cabinets with Shelving Continued

LAS-500(L/R)G Left/Right Framed Glazing Single Door 5 Foot Tall Cabinet	4
LAS-500(L/R)G Left/Right Framed Glazing Single Door 7 Foot Tall Cabinet	5
LAS-500(L/R)V Vented Left/Right Single Door 5 Foot Tall Cabinet	5
LAS-500(L/R)V Vented Left/Right Single Door 7 Foot Tall Cabinet	5
LAS-510 Hinged Solid Double Door 5 Foot Tall Cabinet	5
LAS-510 Hinged Solid Double Door 7 Foot Tall Cabinet	6
LAS-510G Hinged Framed Glazing Double Door 5 Foot Tall Cabinet	6
LAS-510G Hinged Framed Glazing Double Door 7 Foot Tall Cabinet	6
LAS-510V Hinged Vented Double Door 5 Foot Tall Cabinet	6
LAS-510V Hinged Vented Double Door 7 Foot Tall Cabinet	7
LAS-510N Open Shelf Bookcase Base Cabinet.....	7
LAS-510(L/R)B Hinged Solid Double Door Left/Right Blind Corner Cabinet	7
LAS-540(L/R) Hinged Solid Single Left or Right Door Corner Base Cabinet	8
LAS-510V Vented Double Door 3 Foot Fume Hood Base Cabinet With Shelf	3
LAS-510V Vented Double Door 4 Foot Fume Hood Base Cabinet With Shelf	3

Wall Cabinets

LAS-525(L/R)V Vented 5 Foot Fume Hood 3 Door Base Cabinet	3
LAS-525(L/R)V Vented 6 Foot Fume Hood 3 Door Base Cabinet	3
LAS-530V Vented 8 Foot Fume Hood 4 Door Base Cabinet	4
LAS-600(L/R) - Hinged Solid Single Door Wall Cabinet	3
LAS-600(L/R)G Hinged Framed Glazing Single Door Wall Cabinet.....	3
LAS-610 Hinged Solid Double Door Wall Cabinet	3
LAS-620 Solid Sliding Double Door Wall Cabinet.....	3
LAS-610G Hinged Framed Glazing Double Door Wall Cabinet	4
LAS-620G Framed Glazing Sliding Double Door Wall Cabinet.....	4
LAS-610(L/R)B Hinged Solid Double Door Blind Corner Wall Cabinet	4
LAS-610(L/R)BG Hinged Framed Glazing Double Door Blind Corner Wall Cabinet	5

BASE CABINETS WITH DRAWERS



Pictured With Optional Recessed Handles

ABOUT

LAS drawer only base cabinets consist of standard configurations from three drawer up to nine drawer combination cabinets. All LAS base cabinets are available in sitting, standing and ADA compliant heights. LAS uses low friction drawer guides/glides material for effortless operation. LAS also offers an optional soft-close mechanism, allowing the drawers to close silently and smoothly. Custom configurations and sizes are available and welcomed.



LAS-100 Basic (3) Drawer Base Cabinet

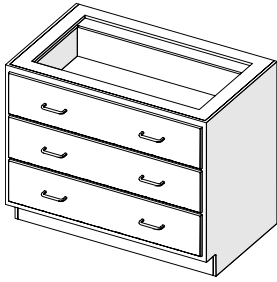

LAS-100-362922

Sitting Height

Model	Width	Height	Depth
LAS-100-182922	18"	29"	22"
LAS-100-242922	24"	29"	22"
LAS-100-302922	30"	29"	22"
LAS-100-362922	36"	29"	22"

Standing Height

Model	Width	Height	Depth
LAS-100-183522	18"	35"	22"
LAS-100-243522	24"	35"	22"
LAS-100-303522	30"	35"	22"
LAS-100-363522	36"	35"	22"

LAS-200 Basic (4) Drawer Base Cabinet

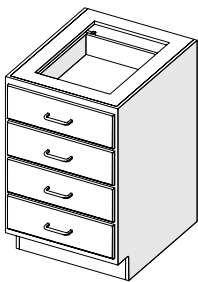

LAS-200-182922

Sitting Height

Model	Width	Height	Depth
LAS-200-182922	18"	29"	22"
LAS-200-242922	24"	29"	22"
LAS-200-302922	30"	29"	22"
LAS-200-362922	36"	29"	22"

Standing Height

Model	Width	Height	Depth
LAS-200-183522	18"	35"	22"
LAS-200-243522	24"	35"	22"
LAS-200-303522	30"	35"	22"
LAS-200-363522	36"	35"	22"

LAS-300 Basic (5) Drawer Base Cabinet

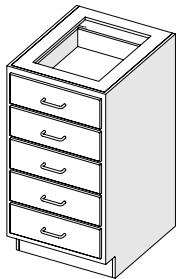

LAS-300-183522

Sitting Height

Model	Width	Height	Depth
LAS-300-182922	18"	29"	22"
LAS-300-242922	24"	29"	22"
LAS-300-302922	30"	29"	22"
LAS-300-362922	36"	29"	22"

Standing Height

Model	Width	Height	Depth
LAS-300-183522	18"	35"	22"
LAS-300-243522	24"	35"	22"
LAS-300-303522	30"	35"	22"
LAS-300-363522	36"	35"	22"

LAS-210 Combination (5) Drawer Base Cabinet

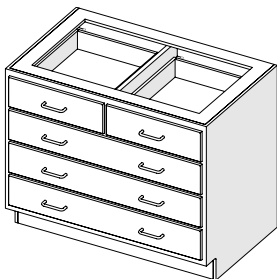

LAS-210-362922

Sitting Height

Model	Width	Height	Depth
LAS-210-302922	30"	29"	22"
LAS-210-362922	36"	29"	22"
LAS-210-422922	42"	29"	22"
LAS-210-482922	48"	29"	22"

Standing Height

Model	Width	Height	Depth
LAS-210-303522	30"	35"	22"
LAS-210-363522	36"	35"	22"
LAS-210-423522	42"	35"	22"
LAS-210-483522	48"	35"	22"

LAS-220 Combination (6) Drawer Base Cabinet



LAS-220-483522

Sitting Height

Model	Width	Height	Depth
LAS-220-302922	30"	29"	22"
LAS-220-362922	36"	29"	22"
LAS-220-422922	42"	29"	22"
LAS-220-482922	48"	29"	22"

Standing Height

Model	Width	Height	Depth
LAS-220-303522	30"	35"	22"
LAS-220-363522	36"	35"	22"
LAS-220-423522	42"	35"	22"
LAS-220-483522	48"	35"	22"

LAS-230 Combination (7) Drawer Base Cabinet

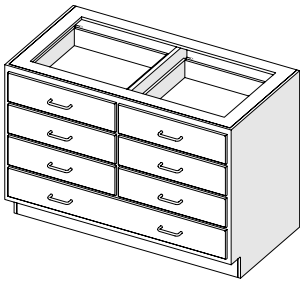

LAS-230-422922

Sitting Height

Model	Width	Height	Depth
LAS-230-302922	30"	29"	22"
LAS-230-362922	36"	29"	22"
LAS-230-422922	42"	29"	22"
LAS-230-482922	48"	29"	22"

Standing Height

Model	Width	Height	Depth
LAS-230-303522	30"	35"	22"
LAS-230-363522	36"	35"	22"
LAS-230-423522	42"	35"	22"
LAS-230-483522	48"	35"	22"

LAS-240 Side By Side (8 Drawer) Drawer Base Cabinet

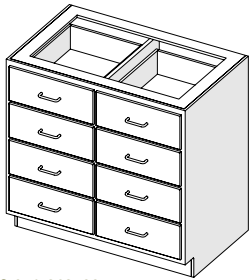

LAS-240-363522

Sitting Height

Model	Width	Height	Depth
LAS-240-302922	30"	29"	22"
LAS-240-362922	36"	29"	22"
LAS-240-422922	42"	29"	22"
LAS-240-482922	48"	29"	22"

Standing Height

Model	Width	Height	Depth
LAS-240-303522	30"	35"	22"
LAS-240-363522	36"	35"	22"
LAS-240-423522	42"	35"	22"
LAS-240-483522	48"	35"	22"

LAS-330 Combination (8) Drawer Base Cabinet

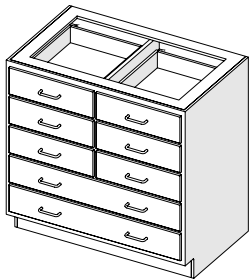

LAS-330-363522

Standing Height

Model	Width	Height	Depth
LAS-330-303522	30"	35"	22"
LAS-330-363522	36"	35"	22"
LAS-330-423522	42"	35"	22"
LAS-330-483522	48"	35"	22"

LAS-340 Combination (9) Drawer Base Cabinet

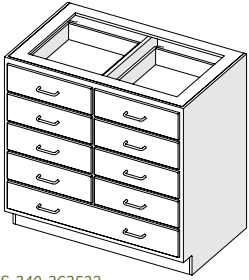

LAS-340-363522

Standing Height

Model	Width	Height	Depth
LAS-340-303522	30"	35"	22"
LAS-340-363522	36"	35"	22"
LAS-340-423522	42"	35"	22"
LAS-340-483522	48"	35"	22"

LAS-350 Side By Side (10 Drawer) Base Cabinet

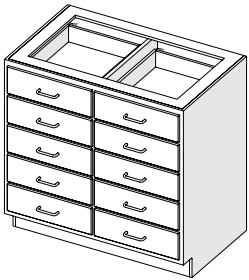

LAS-350-363522

Standing Height

Model	Width	Height	Depth
LAS-350-303522	30"	35"	22"
LAS-350-363522	36"	35"	22"
LAS-350-423522	42"	35"	22"
LAS-350-483522	48"	35"	22"

BASE CABINETS WITH DRAWERS & DOORS



Pictured With Optional Recessed Handles

ABOUT

LAS drawer/door combination base cabinets come with multiple standard configurations of doors (single or double) with up to four drawers. All cabinet doors are fastened with single-piece, recessed knuckle hinges and feature single piece polypropylene pulls. The internal shelves are removeable, adjustable by height and reversible, engineered with a one inch spill containment or a traditional flat surface. Standard base cabinets are available in sitting, standing and ADA compliant heights. LAS uses low friction drawer guides/glides material for effortless operation. LAS also offers an optional soft-close mechanism, allowing the drawers to close silently and smoothly. Custom configurations and sizes are available and welcomed.



LAS-400(L/R) Hinged Solid Single Left/Right — Door/Drawer Base Cabinet



LAS-400R-183522

(1) Adjustable Shelf with 1" Spill Containment Lip

Sitting Height

Model	Width	Height	Depth
LAS-400L-182922	18"	29"	22"
LAS-400R-182922	18"	29"	22"
LAS-400L-242922	24"	29"	22"
LAS-400R-242922	24"	29"	22"

Standing Height

Model	Width	Height	Depth
LAS-400L-183522	18"	35"	22"
LAS-400R-183522	18"	35"	22"
LAS-400L-243522	24"	35"	22"
LAS-400R-243522	24"	35"	22"

LAS-405 Hinged Solid Double Door With Single Drawer Base Cabinet

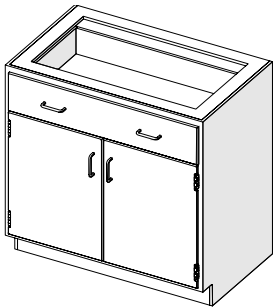

LAS-405-363522

(1) Adjustable Shelf with 1" Spill Containment Lip

Sitting Height

Model	Width	Height	Depth
LAS-405-302922	30"	29"	22"
LAS-405-362922	36"	29"	22"
LAS-405-422922	42"	29"	22"
LAS-405-482922	48"	29"	22"

Standing Height

Model	Width	Height	Depth
LAS-405-303522	30"	35"	22"
LAS-405-363522	36"	35"	22"
LAS-405-423522	42"	35"	22"
LAS-405-483522	48"	35"	22"

LAS-410 Hinged Solid Double Door With (2) Drawer Base Cabinet

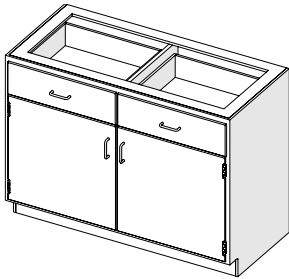

LAS-410-483522

(1) Adjustable Shelf with 1" Spill Containment Lip

Sitting Height

Model	Width	Height	Depth
LAS-410-302922	30"	29"	22"
LAS-410-362922	36"	29"	22"
LAS-410-422922	42"	29"	22"
LAS-410-482922	48"	29"	22"

Standing Height

Model	Width	Height	Depth
LAS-410-303522	30"	35"	22"
LAS-410-363522	36"	35"	22"
LAS-410-423522	42"	35"	22"
LAS-410-483522	48"	35"	22"

LAS-401(L/R) Hinged Single Left/Right Door/ (3) Drawer Base Cabinet

(1) Adjustable Shelf with 1" Spill Containment Lip



LAS-401L-483522

Sitting Height

Model	Width	Height	Depth
LAS-401L-302922	30"	29"	22"
LAS-401R-302922	30"	29"	22"
LAS-401L-362922	36"	29"	22"
LAS-401R-362922	36"	29"	22"
LAS-401L-422922	42"	29"	22"
LAS-401R-422922	42"	29"	22"
LAS-401L-482922	48"	29"	22"
LAS-401R-482922	48"	29"	22"

Standing Height

Model	Width	Height	Depth
LAS-401L-303522	30"	35"	22"
LAS-401R-303522	30"	35"	22"
LAS-401L-363522	36"	35"	22"
LAS-401R-363522	36"	35"	22"
LAS-401L-423522	42"	35"	22"
LAS-401R-423522	42"	35"	22"
LAS-401L-483522	48"	35"	22"
LAS-401R-483522	48"	35"	22"

LAS-402(L/R) Hinged Single Left/Right Door/ (4) Drawer Base Cabinet

(1) Adjustable Shelf with 1" Spill Containment Lip

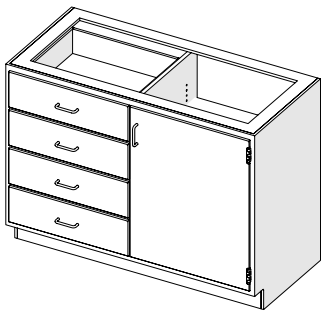

LAS-402R-483522

Sitting Height

Model	Width	Height	Depth
LAS-402L-302922	30"	29"	22"
LAS-402R-302922	30"	29"	22"
LAS-402L-362922	36"	29"	22"
LAS-402R-362922	36"	29"	22"
LAS-402L-422922	42"	29"	22"
LAS-402R-422922	42"	29"	22"
LAS-402L-482922	48"	29"	22"
LAS-402R-482922	48"	29"	22"

Standing Height

Model	Width	Height	Depth
LAS-402L-303522	30"	35"	22"
LAS-402R-303522	30"	35"	22"
LAS-402L-363522	36"	35"	22"
LAS-402R-363522	36"	35"	22"
LAS-402L-423522	42"	35"	22"
LAS-402R-423522	42"	35"	22"
LAS-402L-483522	48"	35"	22"
LAS-402R-483522	48"	35"	22"

BASE, SINK, VENTED, AND TALL CABINETS



Pictured With Optional Recessed Handles

ABOUT

LAS manufactures multiple variations of standard base cabinets to accommodate countertops, sinks, plumbing, internal ventilation, and fume hoods. All cabinet doors are fastened with single-piece, recessed knuckle hinges and single piece polypropylene pulls. The internal, adjustable shelves are reversible, engineered for a one inch spill containment or a traditional flat surface. Standard base cabinets are available in sitting, standing and ADA compliant heights. The LAS tall cabinets range in height from five to seven feet high. Custom configurations and sizes are available and welcomed.



Pictured With Optional Recessed Handles



Pictured With Optional Recessed Handles



Pictured With Optional Recessed Handles

LAS-500(L/R) Left/Right Hinged Full Door Base Cabinet With Shelf

Left or Right Hinged | (1) Adjustable Shelf with 1" Spill Containment Lip

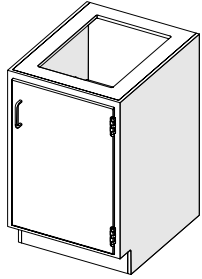

LAS-500R-182922

Sitting Height

Model	Width	Height	Depth
LAS-500L -182922	18"	29"	22"
LAS-500R-182922	18"	29"	22"
LAS-500L-242922	24"	29"	22"
LAS-500R-242922	24"	29"	22"

Standing Height

Model	Width	Height	Depth
LAS-500L -183522	18"	35"	22"
LAS-500R-183522	18"	35"	22"
LAS-500L-243522	24"	35"	22"
LAS-500R-243522	24"	35"	22"

LAS-510 Hinged Double Door Base Cabinet With Shelf

(1) Adjustable Shelf with 1" Spill Containment Lip

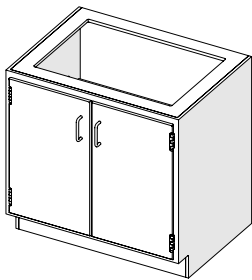

LAS-510-302922

Sitting Height

Model	Width	Height	Depth
LAS-510-302922	30"	29"	22"
LAS-510-362922	36"	29"	22"
LAS-510-422922	42"	29"	22"
LAS-510-482922	48"	29"	22"

Standing Height

Model	Width	Height	Depth
LAS-510-303522	30"	35"	22"
LAS-510-363522	36"	35"	22"
LAS-510-423522	42"	35"	22"
LAS-510-483522	48"	35"	22"

LAS-510S Hinged Double Door Sink Cabinet No Shelf

(1) Removable Plumbing Access Panel

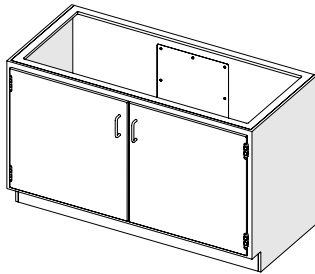

LAS-510S-482922

Sitting Height

Model	Width	Height	Depth
LAS-510S-302922	30"	29"	22"
LAS-510S-362922	36"	29"	22"
LAS-510S-422922	42"	29"	22"
LAS-510S-482922	48"	29"	22"

Standing Height

Model	Width	Height	Depth
LAS-510S-303522	30"	35"	22"
LAS-510S-363522	36"	35"	22"
LAS-510S-423522	42"	35"	22"
LAS-510S-483522	48"	35"	22"

LAS-510V Vented Acid Storage Double Door Base Cabinet With Shelf

(1) Adjustable Shelf with 1" Spill Containment Lip | (1) Polypro Vent 2" FPT Half Coupling

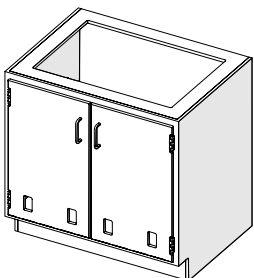

LAS-510V-302922

Sitting Height

Model	Width	Height	Depth
LAS-510V-302922	30"	29"	22"
LAS-510V-362922	36"	29"	22"
LAS-510V-422922	42"	29"	22"
LAS-510V-482922	48"	29"	22"

Standing Height

Model	Width	Height	Depth
LAS-510V-303522	30"	35"	22"
LAS-510V-363522	36"	35"	22"
LAS-510V-423522	42"	35"	22"
LAS-510V-483522	48"	35"	22"

LAS-511S ADA Open Sink Cabinet With Angle Board

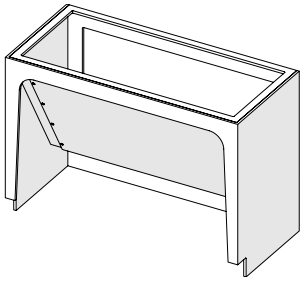

LAS-511S-483322

- (1) Removable Angle Board
- (1) Removable Plumbing Access Panel

Model	Width	Height	Depth
LAS-511S-303322	30"	33"	22"
LAS-511S-363322	36"	33"	22"
LAS-511S-423322	42"	33"	22"
LAS-511S-483322	48"	33"	22"

LAS-500(L/R) Left/Right Solid Single Door 5 Foot Tall Cabinet

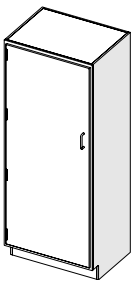

LAS-500L-246018

- Left or Right Hinged
- Shelves Have 1" Spill Containment Lip
- (1) Fixed Shelf | (2) Adjustable Shelves

Model	Width	Height	Depth
LAS-500L-186018	18"	60"	18"
LAS-500R-186018	18"	60"	18"
LAS-500L-246018	24"	60"	18"
LAS-500R-246018	24"	60"	18"

LAS-500(L/R) Left/Right Solid Single Door 7 Foot Tall Cabinet

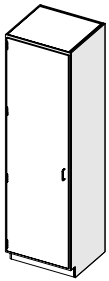

LAS-500L-248422

- Left or Right Hinged
- Shelves Have 1" Spill Containment Lip
- (1) Fixed Shelf | (4) Adjustable Shelves

Model	Width	Height	Depth
LAS-500L-188422	18"	84"	22"
LAS-500R-188422	18"	84"	22"
LAS-500L-248422	24"	84"	22"
LAS-500R-248422	24"	84"	22"

LAS-500(L/R)G Left/Right Framed Glazing Single Door 5 Foot Tall Cabinet

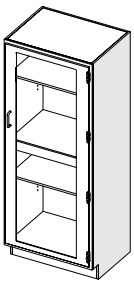

LAS-500RG-246018

- Left or Right Hinged
- Shelves Have 1" Spill Containment Lip
- (1) Fixed Shelf | (2) Adjustable Shelves

Model	Width	Height	Depth
LAS-500LG-186018	18"	60"	18"
LAS-500RG-186018	18"	60"	18"
LAS-500LG-246018	24"	60"	18"
LAS-500RG-246018	24"	60"	18"

LAS-500(L/R)G Left/Right Framed Glazing Single Door 7 Foot Tall Cabinet

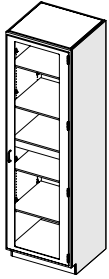

LAS-500RG-188422

Left or Right Hinged
Shelves Have 1" Spill Containment Lip
(1) Fixed Shelf | (4) Adjustable Shelves

Model	Width	Height	Depth
LAS-500LG-188422	18"	84"	22"
LAS-500RG-188422	18"	84"	22"
LAS-500LG-248422	24"	84"	22"
LAS-500RG-248422	24"	84"	22"

LAS-500(L/R)V Vented Left/Right Single Door 5 Foot Tall Cabinet

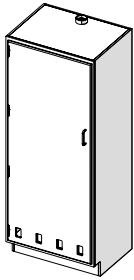

LAS-500LV-246018

Left or Right Hinged
Shelves Have 1" Spill Containment Lip
(1) Fixed Shelf | (2) Adjustable Shelves | (1) 2" FPT Vent Half Coupling

Model	Width	Height	Depth
LAS-500LV-186018	18"	60"	18"
LAS-500RV-186018	18"	60"	18"
LAS-500LV-246018	24"	60"	18"
LAS-500RV-246018	24"	60"	18"

LAS-500(L/R)V Vented Left/Right Single Door 7 Foot Tall Cabinet

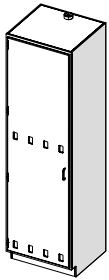

LAS-500LV-248422

Left or Right Hinged
Shelves Have 1" Spill Containment Lip
(1) Fixed Shelf | (4) Adjustable Shelves | (1) 2" FPT Vent Half Coupling

Model	Width	Height	Depth
LAS-500LV-188422	18"	84"	22"
LAS-500RV-188422	18"	84"	22"
LAS-500LV-248422	24"	84"	22"
LAS-500RV-248422	24"	84"	22"

LAS-510 Hinged Solid Double Door 5 Foot Tall Cabinet

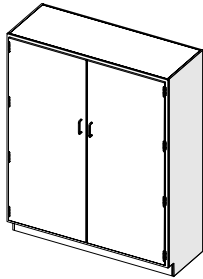

LAS-510-486018

Shelves Have 1" Spill Containment Lip | (1) Fixed Shelf | (2) Adjustable Shelves

Model	Width	Height	Depth
LAS-510-306018	30"	60"	18"
LAS-510-366018	36"	60"	18"
LAS-510-426018	42"	60"	18"
LAS-510-486018	48"	60"	18"

LAS-510 Hinged Solid Double Door 7 Foot Tall Cabinet

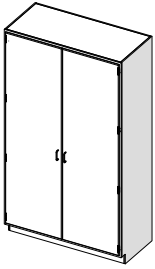

LAS-510-488422

Shelves Have 1" Spill Containment Lip | (1) Fixed Shelf | (4) Adjustable Shelves

Model	Width	Height	Depth
LAS-510-308422	30"	84"	22"
LAS-510-368422	36"	84"	22"
LAS-510-428422	42"	84"	22"
LAS-510-488422	48"	84"	22"

LAS-510G Hinged Framed Glazing Double Door 5 Foot Tall Cabinet

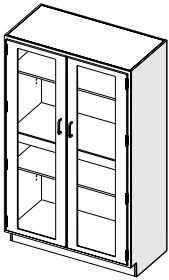

LAS-510-488418

Shelves Have 1" Spill Containment Lip | (1) Fixed Shelf | (2) Adjustable Shelves

Model	Width	Height	Depth
LAS-510G-306018	30"	60"	18"
LAS-510G-366018	36"	60"	18"
LAS-510G-426018	42"	60"	18"
LAS-510G-486018	48"	60"	18"

LAS-510G Hinged Framed Glazing Double Door 7 Foot Tall Cabinet

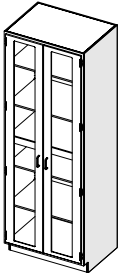

LAS-510G-308422

Shelves Have 1" Spill Containment Lip | (1) Fixed Shelf | (4) Adjustable Shelves

Model	Width	Height	Depth
LAS-510G-308422	30"	84"	22"
LAS-510G-368422	36"	84"	22"
LAS-510G-428422	42"	84"	22"
LAS-510G-488422	48"	84"	22"

LAS-510V Hinged Vented Double Door 5 Foot Tall Cabinet

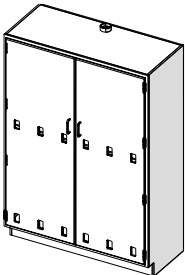

LAS-510V-426018

Shelves Have 1" Spill Containment Lip | (1) Fixed Shelf | (2) Adjustable Shelves

Model	Width	Height	Depth
LAS-510V-306018	30"	60"	18"
LAS-510V-366018	36"	60"	18"
LAS-510V-426018	42"	60"	18"
LAS-510V-486018	48"	60"	18"

LAS-510V Hinged Vented Double Door 7 Foot Tall Cabinet

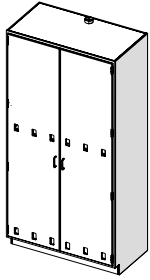

LAS-510V-428422

Shelves Have 1" Spill Containment Lip | (1) Fixed Shelf | (4) Adjustable Shelves

Model	Width	Height	Depth
LAS-510V-308422	30"	84"	22"
LAS-510V-368422	36"	84"	22"
LAS-510V-428422	42"	84"	22"
LAS-510V-488422	48"	84"	22"

LAS-510N Open Shelf Bookcase Base Cabinet

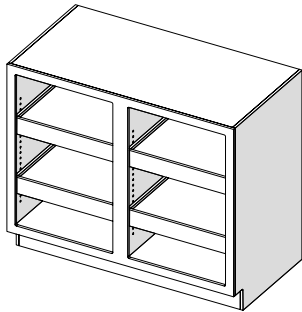

LAS-510N-423522

LAS-510N-18 & LAS-510N-24 Models: (2) Adjustable Shelves with 1" Spill Containment Lip
All Other Models: (4) Adjustable Shelves with 1" Spill Containment Lip

Sitting Height				Standing Height			
Model	Width	Height	Depth	Model	Width	Height	Depth
LAS-510N-182922	18"	29"	22"	LAS-510N-183522	18"	35"	22"
LAS-510N-242922	24"	29"	22"	LAS-510N-243522	24"	35"	22"
LAS-510N-302922	30"	29"	22"	LAS-510N-303522	30"	35"	22"
LAS-510N-362922	36"	29"	22"	LAS-510N-363522	36"	35"	22"
LAS-510N-422922	42"	29"	22"	LAS-510N-423522	42"	35"	22"
LAS-510N-482922	48"	29"	22"	LAS-510N-483522	48"	35"	22"

LAS-510(L/R)B Hinged Solid Double Door Left/Right Blind Corner Cabinet

(1) Fixed Shelf with 1" spill Containment Lip

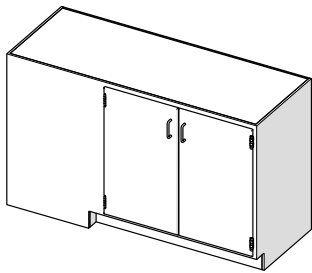

LAS-510LB-363522

Sitting Height				Standing Height			
Model	Width	Height	Depth	Model	Width	Height	Depth
LAS-510LB-302922	52"	29"	22"	LAS-510LB-303522	52"	35"	22"
LAS-510RB-302922	52"	29"	22"	LAS-510RB-303522	52"	35"	22"
LAS-510LB-362922	58"	29"	22"	LAS-510LB-363522	58"	35"	22"
LAS-510RB-362922	58"	29"	22"	LAS-510RB-363522	58"	35"	22"
LAS-510LB-422922	64"	29"	22"	LAS-510LB-423522	64"	35"	22"
LAS-510RB-422922	64"	29"	22"	LAS-510EB-423522	64"	35"	22"
LAS-510LB-482922	70"	29"	22"	LAS-510LB-483522	70"	35"	22"
LAS-510RB-482922	70"	29"	22"	LAS-510RB-483522	70"	35"	22"

LAS-540(L/R) Hinged Solid Single Left or Right Door Corner Base Cabinet

(1) Fixed Shelf with 1" Spill Containment Lip

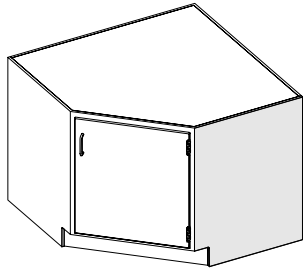

Sitting Height

Model	Width	Height	Depth
LAS-540L-122922	12"	29"	22"
LAS-540R-122922	12"	29"	22"
LAS-540L-162922	16"	29"	22"
LAS-540R-162922	16"	29"	22"

Standing Height

Model	Width	Height	Depth
LAS-540L-123522	12"	35"	22"
LAS-540R-123522	12"	35"	22"
LAS-540L-163522	16"	35"	22"
LAS-540R-163522	16"	35"	22"

LAS-540R-162922

FUME HOOD BASE CABINETS



Pictured With Optional Recessed Handles

ABOUT

LAS manufactures multiple base cabinets and base stands to support our Fume Hoods and Enclosures, and are designed to accommodate countertops, sinks, plumbing and internal ventilation. Standard base cabinets and stands are available in sitting, standing and ADA compliant heights; made of ½" stress-relieved polypropylene and can be vented for chemical storage. Other non-polypropylene options include flammable storage cabinets and painted metal base stands. All LAS base cabinet structures are manufactured to optimize space and safely support each Fume Hood.



Pictured With Optional Recessed Handles



Pictured With Optional Recessed Handles



Pictured With Optional Recessed Handles

LAS-510V Vented Double Door 3 Foot Fume Hood Base Cabinet With Shelf

(1) Adjustable Shelf with 1" Spill Containment Lip | (1) Polypro Vent 2" FPT Half Coupling

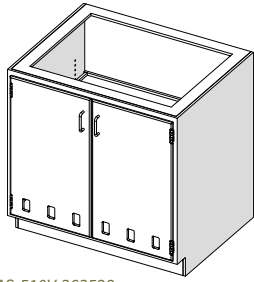

LAS-510V-363528

24" Deep Work Surface Hood

Model	Width	Height	Depth
LAS-510V-363522	36"	35"	22"
LAS-510VS-363522	36"	35"	22"

30" Deep Work Surface Hood

Model	Width	Height	Depth
LAS-510V-363528	36"	35"	28"
LAS-510VS-363528	36"	35"	28"

LAS-510V Vented Double Door 4 Foot Fume Hood Base Cabinet With Shelf

(1) Adjustable Shelf with 1" Spill Containment Lip | (1) Polypro Vent 2" FPT Half Coupling

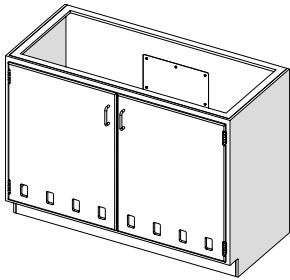

LAS-510VS-483522

24" Deep Work Surface Hood

Model	Width	Height	Depth
LAS-510V-483522	48"	35"	22"
LAS-510VS-483522	48"	35"	22"

30" Deep Work Surface Hood

Model	Width	Height	Depth
LAS-510V-483528	48"	35"	28"
LAS-510VS-483528	48"	35"	28"

LAS-525(L/R)V Vented 5 Foot Fume Hood 3 Door Base Cabinet

(1) Divider (Specify Side) | (2) Adjustable Shelves with 1" Spill Containment | (2) Polypro Vents 2" FPT Half Couplings
 **Note: Can Be Ordered With or Without Vents or Shelves

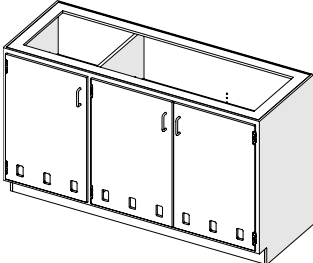

LAS-525LV-603522

24" Deep Work Surface Hood

Model	Width	Height	Depth
LAS-520V-603522	60"	35"	22"
LAS-520(L/R)VS-603522	60"	35"	22"

30" Deep Work Surface Hood

Model	Width	Height	Depth
LAS-510V-603528	60"	35"	28"
LAS-525(L/R)VS-603528	60"	35"	28"

LAS-525(L/R)V Vented 6 Foot Fume Hood 3 Door Base Cabinet

(1) Divider (Specify Side) | (2) Adjustable Shelves with 1" Spill Containment | (2) Polypro Vents 2" FPT Half Couplings
 **Note: Can Be Ordered With or Without Vents or Shelves

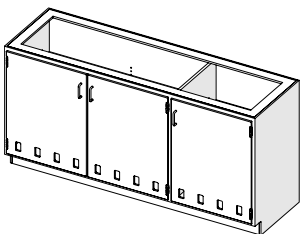

LAS-525RV-723522

Model	Width	Height	Depth
LAS-525V-723522	72"	35"	22"
LAS-525V-723528	72"	35"	28"

LAS-530V Vented 8 Foot Fume Hood 4 Door Base Cabinet

(1) Divider | (2) Adjustable Shelves with 1" Spill Containment | (2) Polypro Vents 2" FPT Half Couplings
 **Note: Can Be Ordered With or Without Vents or Shelves

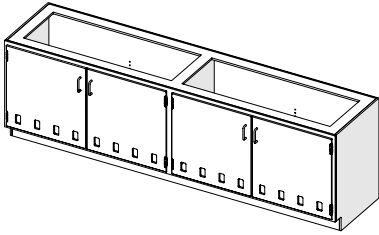

Model

LAS-530V-963522
 LAS-530V-963528

Width	Height	Depth
96"	35"	22"
96"	35"	28"

LAS-530V-962922

WALL CABINETS & SHELVING



Pictured With Optional Recessed Handles

ABOUT

LAS wall cabinets are single piece construction with single-piece, recessed knuckle hinges and polypropylene pulls. The internal, adjustable shelves are reversible, engineered with a one inch spill containment or a traditional flat surface. All cabinets come with either solid door or polycarbonate glazing, and adjustable shelves with one inch spill containment. Standard wall cabinets are available 12 inches deep and either 24 inches or 30 inches tall. Custom configurations and sizes are available and welcomed.



Pictured With Optional Recessed Handles



LAS-600(L/R) - Hinged Solid Single Door Wall Cabinet

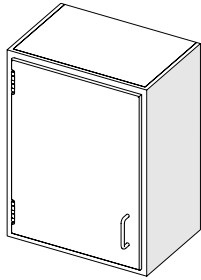

LAS-600L-182412

24" Tall Cabinet comes with (1) Adjustable Shelf with 1" Spill Containment Lip
30" Tall Cabinet comes with (2) Adjustable Shelves with 1" Spill Containment Lip

Model	Width	Height	Depth	Model	Width	Height	Depth
LAS-600L-182412	18"	24"	12"	LAS-600L-242412	24"	24"	12"
LAS-600R-182412	18"	24"	12"	LAS-600R-242412	24"	24"	12"
LAS-600L-183012	18"	30"	12"	LAS-600L-243012	24"	30"	12"
LAS-600R-183012	18"	30"	12"	LAS-600R-243012	24"	30"	12"

LAS-600(L/R)G Hinged Framed Glazing Single Door Wall Cabinet

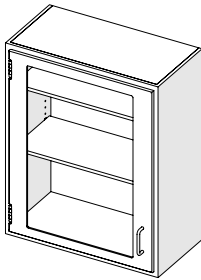

LAS-600LG-243012-30

24" Tall Cabinet comes with (1) Adjustable Shelf with 1" Spill Containment Lip
30" Tall Cabinet comes with (2) Adjustable Shelves with 1" Spill Containment Lip

Model	Width	Height	Depth	Model	Width	Height	Depth
LAS-600LG-182412	18"	24"	12"	LAS-600LG-242412	24"	24"	12"
LAS-600RG-182412	18"	24"	12"	LAS-600RG-242412	24"	24"	12"
LAS-600LG-183012	18"	30"	12"	LAS-600LG-243012	24"	30"	12"
LAS-600RG-183012	18"	30"	12"	LAS-600RG-243012	24"	30"	12"

LAS-610 Hinged Solid Double Door Wall Cabinet

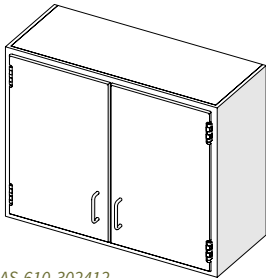

LAS-610-302412

24" Tall Cabinet comes with (1) Adjustable Shelf with 1" Spill Containment Lip
30" Tall Cabinet comes with (2) Adjustable Shelves with 1" Spill Containment Lip

Model	Width	Height	Depth	Model	Width	Height	Depth
LAS-610-302412	30"	24"	12"	LAS-610-303012	30"	30"	12"
LAS-610-362412	36"	24"	12"	LAS-610-363012	36"	30"	12"
LAS-610-422412	42"	24"	12"	LAS-610-423012	42"	30"	12"
LAS-610-482412	48"	24"	12"	LAS-610-483012	48"	30"	12"

LAS-620 Solid Sliding Double Door Wall Cabinet

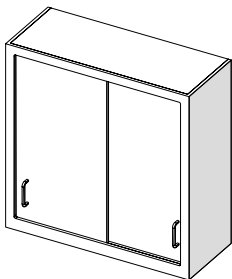

LAS-620-303012

24" Tall Cabinet comes with (1) Adjustable Shelf with 1" Spill Containment Lip
30" Tall Cabinet comes with (2) Adjustable Shelves with 1" Spill Containment Lip
Note: Recessed handles not available on sliding doors

Model	Width	Height	Depth	Model	Width	Height	Depth
LAS-620-302412	30"	24"	12"	LAS-620-303012	30"	30"	12"
LAS-620-362412	36"	24"	12"	LAS-620-363012	36"	30"	12"
LAS-620-422412	42"	24"	12"	LAS-620-423012	42"	30"	12"
LAS-620-482412	48"	24"	12"	LAS-620-483012	48"	30"	12"

LAS-610G Hinged Framed Glazing Double Door Wall Cabinet

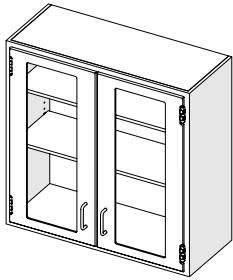

24" Tall Cabinet comes with (1) Adjustable Shelf with 1" Spill Containment Lip
 30" Tall Cabinet comes with (2) Adjustable Shelves with 1" Spill Containment Lip

Model	Width	Height	Depth	Model	Width	Height	Depth
LAS-610G-302412	30"	24"	12"	LAS-610G-303012	30"	30"	12"
LAS-610G-362412	36"	24"	12"	LAS-610G-363012	36"	30"	12"
LAS-610G-422412	42"	24"	12"	LAS-610G-423012	42"	30"	12"
LAS-610G-482412	48"	24"	12"	LAS-610G-483012	48"	30"	12"

LAS-610G-303012

LAS-620G Framed Glazing Sliding Double Door Wall Cabinet

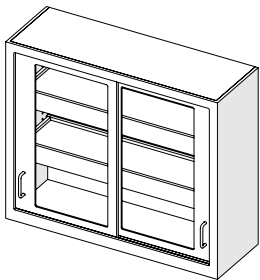

24" Tall Cabinet comes with (1) Adjustable Shelf with 1" Spill Containment Lip
 30" Tall Cabinet comes with (2) Adjustable Shelves with 1" Spill Containment Lip
 Note: Recessed handles not available on sliding doors

Model	Width	Height	Depth	Model	Width	Height	Depth
LAS-620G-302412	30"	24"	12"	LAS-620G-303012	30"	30"	12"
LAS-620G-362412	36"	24"	12"	LAS-620G-363012	36"	30"	12"
LAS-620G-422412	42"	24"	12"	LAS-620G-423012	42"	30"	12"
LAS-620G-482412	48"	24"	12"	LAS-620G-483012	48"	30"	12"

LAS-620G-363012

LAS-610(L/R)B Hinged Solid Double Door Blind Corner Wall Cabinet

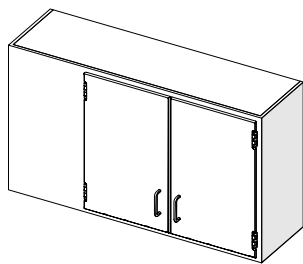

24" Tall Cabinet comes with (1) Adjustable Shelf with 1" Spill Containment Lip
 30" Tall Cabinet comes with (2) Adjustable Shelves with 1" Spill Containment Lip
 Note: Specify Left or Right Blind Corner area.

Model	Width	Height	Depth	Model	Width	Height	Depth
LAS-610LB-302412	42"	24"	12"	LAS-610LB-303012	42"	30"	12"
LAS-610RB-302412	42"	24"	12"	LAS-610RB-303012	42"	30"	12"
LAS-610LB-362412	48"	24"	12"	LAS-610LB-363012	48"	30"	12"
LAS-610RB-362412	48"	24"	12"	LAS-610RB-363012	48"	30"	12"
LAS-610LB-422412	54"	24"	12"	LAS-610LB-423012	54"	30"	12"
LAS-610RB-422412	54"	24"	12"	LAS-610RB-423012	54"	30"	12"
LAS-610LB-482412	60"	24"	12"	LAS-610LB-483012	60"	30"	12"
LAS-610RB-482412	60"	24"	12"	LAS-610RB-483012	60"	30"	12"

LAS-610LB-302412

LAS-610(L/R)BG Hinged Framed Glazing Double Door Blind Corner Wall Cabinet

24" Tall Cabinet comes with (1) Fixed Shelf with 1" Spill Containment Lip
 30" Tall Cabinet comes with (2) Fixed Shelves with 1" Spill Containment Lip
 Note: Specify Left or Right Blind Corner area.

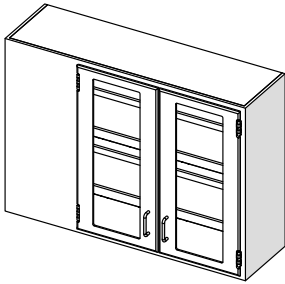

LAS-610L BG-303012

Model	Width	Height	Depth	Model	Width	Height	Depth
LAS-610L BG-302412	42"	24"	12"	LAS-610L BG-303012	42"	30"	12"
LAS-610R BG-302412	42"	24"	12"	LAS-610R BG-303012	42"	30"	12"
LAS-610L BG-362412	48"	24"	12"	LAS-610L BG-363012	48"	30"	12"
LAS-610R BG-362412	48"	24"	12"	LAS-610R BG-363012	48"	30"	12"
LAS-610L BG-422412	54"	24"	12"	LAS-610L BG-423012	54"	30"	12"
LAS-610R BG-422412	54"	24"	12"	LAS-610R BG-423012	54"	30"	12"
LAS-610L BG-482412	60"	24"	12"	LAS-610L BG-483012	60"	30"	12"
LAS-610R BG-482412	60"	24"	12"	LAS-610R BG-483012	60"	30"	12"

LAS-610N Open Shelf Wall Cabinet

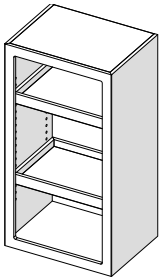

LAS-610N-18 & LAS-610N-24 Models: (2) Adjustable Shelves with 1" Spill Containment Lip
 All Other Models: (4) Adjustable Shelves with 1" Spill Containment Lip

LAS-610N-422412

Model	Width	Height	Depth	Model	Width	Height	Depth
LAS-610N-182412	18"	24"	12"	LAS-610N-183012	18"	30"	12"
LAS-610N-242412	24"	24"	12"	LAS-610N-243012	24"	30"	12"
LAS-610N-302412	30"	24"	12"	LAS-610N-303012	30"	30"	12"
LAS-610N-362412	36"	24"	12"	LAS-610N-363012	36"	30"	12"
LAS-610N-422412	42"	24"	12"	LAS-610N-423012	42"	30"	12"
LAS-610N-482412	48"	24"	12"	LAS-610N-483012	48"	30"	12"

LAS-640N Single Open Shelf Corner Wall Cabinet

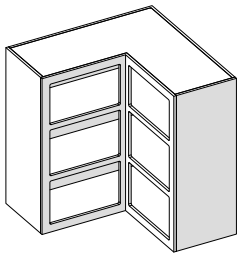

24" Tall Cabinet comes with (1) Fixed Shelf with 1" Spill Containment Lip
 30" Tall Cabinet comes with (2) Fixed Shelves with 1" Spill Containment Lip

LAS-640N-163012

Model	Width	Height	Depth	Model	Width	Height	Depth
LAS-640N-122412	12"	24"	12"	LAS-640N-123012	12"	30"	12"
LAS-640N-162412	16"	24"	12"	LAS-640N-163012	16"	30"	12"