

AFI presents
THE GENERATION

ISA

CENTRIFUGES FOR CLINIC AND CHEMISTRY

From Experience comes Excellence



2023



Groups



LIA

Rotor 24 micro tubes
15 000 Rpm/ 21 380 x g
Ventilated & Refrigerated
8 rotors

LINA

Rotor 48 micro tubes
Rotor 6x 50mL
Rotor 6 Micro plates
23 000 Rpm/ 39 625x g
Ventilated & Refrigerated
11 rotors

SIRENA

24-36 tubes 5/7 mL
6x 100mL
18 000 Rpm/ 31514 x g
Refrigerated
Interactive display
Touch screen, 99 programs,
17 rotors

ISA

40 tubes 5/7 mL
6700 Rpm/ 6324 xg
Ventilated & Refrigerated
Touch Screen, 99 programs,
11 rotors

Micro
Research centers / Veterinaire



Performance
Research centers/ Universities

Compact
Small laboratories



High Capacity
Blood bank / Industry



Groups

Routine
Hospitals / Medical analysis Laboratories

KATRINA

12 Liters
4900 Rpm/ 7301 x g
Refrigerated Floor
Interactive communication, Touch screen,
Integral, 6 Rotors

LOREENA

108- 200 tubes 5/7 mL / 12x 50 mL
16000 Rpm/ 28 335x g
Ventilated & Refrigerated & Floor
Interactive communication,
Click Spin, Touch Screen,
15 Rotors

LISA

60-92 tubes 5-7 mL/ 8x100mL
18 000 Rpm/ 31514 x g
Ventilated & Refrigerated
Interactive Communication, Click Spin, Touch
Screen, 18 Rotors

Centrifuge COMPACT-LINE

ALL OF A BIG

ISA will be indispensable for your daily laboratory tasks in small offices and hospitals. Up to 40 5/7mL tubes can be centrifuged in dedicated applications.

POLYVALENT

It is ideal for clinical chemistry but will also find its place in research laboratories with its range of angle rotors 15mL, 50mL, 85mL, no tube can resist it.

COMPACT

Thanks to its compactness and small size, ISA will be discreet and easy to place on your benches. It will go from 0.4 to 0.6L and thus provide support on a rise in activity.

SMALL AND CUTE

Its small and cute design will seduce you. The central wheel and large display will make your navigation easier. She will become your best friend.

CITOLOGY APPLICATION

Citology application is available on ISA, thanks to the dedicated rotor. You can centrifuge 12 simple or double funnels.



Centrifuge Description		
AFI-CI060V-E	ISA Centrifuge Ventilated	
AFI-CI060R-E	ISA Centrifuge Refrigerated	
AFI-CI060RH-E	ISA Centrifuge Heated	
Specifications	Swing-out rotor	Angular Rotor
Max Speed	4500rpm	6700rpm
Max RCF	3396g	6331g
Max Loading	4x150ml	6x85ml
Dim. (HxWxD)	34x39x51cm	
Pack dim.	47x47x70cm	
Weight	40kg	

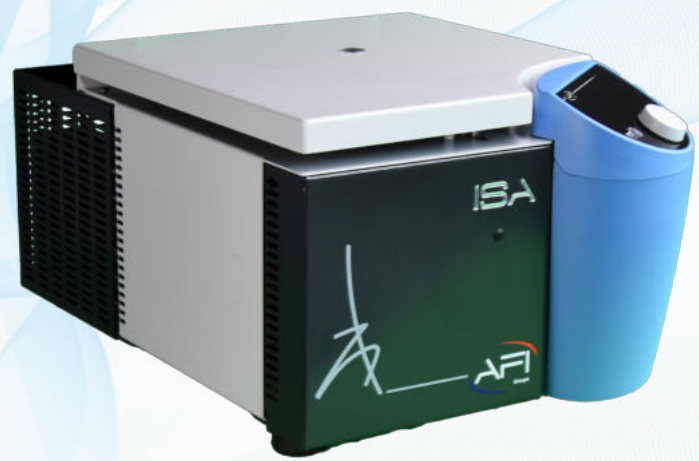

Our best compact clinical centrifuge



COMPACT

Thanks to its compactness and small size, ISA will be perfect for your laboratory tasks. Up to 40 tubes 5/7 mL can be centrifuged.

INTERNATIONAL AUTOMATIC ELECTRICAL CORRECTION



International automatic correction of the electrical network. Guarantees stability of the machine's performance.

INTERACTIVE DISPLAY



With its digital LCD display, tilted for better visibility, ISA will help you to get started with the machine.

A real pleasure of simplicity.

Its major assets

6 reasons

to choose it



Updating centrifuges by a simple USB connection on the front panel.

USB CONNECTION

Centrifuge's electronic functions integrated into a front central unit. Plug & play system guaranteeing a fast and efficient intervention

THE BLUE BOX



SMART COLOR COMMUNICATION

With its unique illuminated displays, ISA will monitor your samples and confirm whether or not the cycle is running smoothly

Swinging bucket rotors

Accessories selection guide



ISA ACCESSORIES	AFI-RXN100	AFI-RXN150			AFI-RHDW-N150	AFI-RCYTO-N150
-----------------	------------	------------	--	--	---------------	----------------



ISA ACCESSORIES	-	AFI-B150	AFI-SB150	AFI-DB50*	AFI-BHDW-N150*	-
-----------------	---	----------	-----------	-----------	----------------	---

Max Capacity (ml)	4x100	4x150	4x150	8x50	8 Microplates	12 Funnels
Max Charge (gr)		260	260	2x67	575	
Max Speed (rpm)	4 100	4 500	4 500	4 500	4 500	2 000
Max RCF (g)	2 932	3 396	3 419	3 464	2 400	438
Cavity dim (ØxD) or (WxLxD)		Ø51x97	52x52x97	Ø30x70	91x132x35	
Lid		✓	✓			
Acc/ Dec (s)	55 55	70 60				

Tubes	ml	Ø x L						
	1,1-1,4	8x82	32	32	36	24	-	-
	1,5-2	11x38	-	48	72	24	-	-
	1,5-2	12,5x40	-	32	36	24	-	-
	1,3	10x45	32	32	36	24	-	-
	1,6-7	13x75-100	40	24	36	8	-	-
	2,6-4,9	13x81-106	40	24	36	8	-	-
	1,2-5	11x82-108	40	24	36	8	-	-
	4-8,5	15x91-108	28	16	24	8	-	-
	7-10	16x100	28	16	24	8	-	-
	10	21x90	-	12	16	8	-	-
	15	17x120	12	8	8	8	-	-
	30	25x110	-	4	4	8	-	-
	30	25x110	-	4	4	8	-	-
	30	25x95	-	4	4	8	-	-
	50	29x115	-	4	4	8	-	-
	50	29x115	4	4	4	8	-	-
	50 OAK	29x107	-	4	4	8	-	-
	80 OAK85 OAK	38x106	-	4	4	8	-	-
	100	44x100	4	-	-	-	-	-
	Micro Plates		-	-	-	-	8	-
	Deep Well		-	-	-	-	2	-
	Funnel		-	-	-	-	-	12

* Unsealed

AFI RXN-100

Adapters selection guide



DEDICATED PLASTIC BUCKETS

Model	V	R
Max Capacity	4 x 100ml	
Angle	90°	
RPM Max	4 100	4 100
ACR Max	2 932	2 932

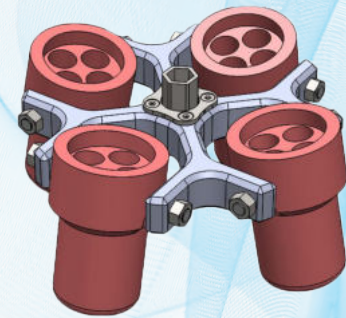

Accessories



Ref.	AFI-RXN100
------	------------

Tubes

Capacity (ml)	1,1-1,4		1,3		1,6-5		5-7	
∅ x L (mm)	8x82		10x45		13x75		13x100	
Tubes per adapter / rotor	8 32	13 52	8 32	13 52	7 28	10 40	7 28	10 40

Adapter

Hole ∅ x L (mm)	9,5x55	9,5x55	11x40	11x40	13,5x58	13,5x58	13,5x80	13,5x80
Radius (mm)	120	125	99	100	131	132	141	143
Max Charge (gr)	120	200	80g	200	120	200	120	200
Ref.	ISA-PRBT1	ISA-PSBT1	ISA-PRBT1.3	ISA-PSBT1.3	ISA-PRBT5	ISA-PSBT5	ISA-PRBT6	ISA-PSBT6

Tubes

Capacity (ml)	2,6-4,9		5-7		2,7-3		4,5-5	
∅ x L (mm)	13x81		13x100		11x82		11x108	
Tubes per adapter / rotor	7 28	10 40	7 28	10 40	8 32	13 52	8 32	13 52

Adapter

Hole ∅ x L (mm)	13,5x58	13,5x58	13,5x80	13,5x80	12,5x55	12,5x55	12,5x80	12,5x80
Radius (mm)	131	132	141	143	120	125	137	139
Max Charge (gr)	120	200	120	200	120	200	120	200
Ref.	ISA-PRBT5	ISA-PSBT5	ISA-PRBT6	ISA-PSBT6	ISA-PRBT5ST	ISA-PSBT5ST	ISA-PRBT6ST	ISA-PSBT6ST

Tubes

Capacity (ml)	4-8,5		7-10		15	50	100
∅ x L (mm)	15x91 108		16x100		17x120	29x115	44x100
Tubes per adapter / rotor	4 16	7 28	4 16	7 28	3 12	1 4	1 4

Adapter

Hole ∅ x L (mm)	17,5x 80	17,5x 83	17,5x 80	17,5x 83	18x80	30x70	46x80
Radius (mm)	142	145	142	145	156	147	147
Max Charge (gr)	120	200	120	200	100	120	200
Ref.	ISA-PRBT10	ISA-PSBT10	ISA-PRBT10	ISA-PSBT10	ISA-PRBT15C	ISA-PRBT50C	ISA-PRBT100

AFI RXN-150

Adapters selection guide



AFI-B150 : ROUND BUCKETS

Model	V	R
Max Capacity	4 x 150ml	
Angle	90°	
RPM Max	4 500	4 500
ACR Max	3 396	3 396

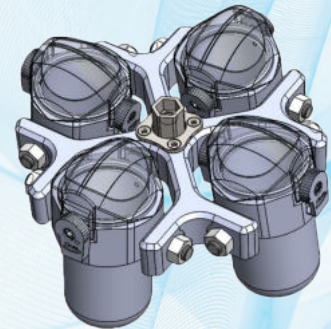

Accessories



Ref.	AFI-RXN150	AFI-B150*	AFI-L150*	AFI-SB150*	AFI-LSB150*	AFI-DB50*
------	------------	-----------	-----------	------------	-------------	-----------

* Set of 4

Tubes

	1,1-1,4	1,5-2	1,5-2	1,3	1,6-7	2,6-4,9	1,2-5	4-8,5	7-10	10
Capacity (ml)	1,1-1,4	1,5-2	1,5-2	1,3	1,6-7	2,6-4,9	1,2-5	4-8,5	7-10	10
Ø x L (mm)	8x82	11x38	12,5x40	10x45	13x75 100	13x81 106	11x82 108	15x91 108	16x100	21x90
Tubes per adapter / rotor	8 32	12 48	8 32	9 36	6 24		8 32	4 16		3 12
Adapter										
Hole Ø x L(mm)	9x50	11,25x40	13x30	11x40	13,5x58		12,5x55	17x58		22x80
Radius	150	145	125	143	148		140	148		150
Max Charge (gr)	260									
Ref.	AFI-06T1	AFI-06T2	AFI-06T2CRYO	AFI-06T1.3	AFI-06T5*		AFI-06T5ST*	AFI-06T10		AFI-06T10C

* For tube length > 80mm and ACR > 3000g, we preconise using adapter AFI-06T6 or AFI-06T6ST

Tubes

	15	30	30	30	50	50	50	50	80 / 85	100
Capacity (ml)	15	30	30	30	50	50	50	50	80 / 85	100
Ø x L (mm)	17x120	25x110	25x110	25x95	29x115	29x115	29x115	29x107	38x106	44x100
Tubes per adapter / rotor	2 8	1 4	1 4	1 4	1 4	1 4	1 4	1 4	1 4	1 4
Adapter										
Hole Ø x L(mm)	18x80	26x60	26x60	26,5x70	30x70	30x70	30x70	30x70	40x78	46x90
Radius	150	148	147	148	149	149	150	149	149	148
Max Charge (gr)	260									
Ref.	AFI-06T15C	AFI-06T30S	AFI-06T30C	AFI-06T30AOR	AFI-06T50S	AFI-06T50CS*	AFI-06T50C	AFI-06T50AOR	AFI-06T80AOR	AFI-06T100

* For protocols < 3500g



AFI-SB150 : SQUARE BUCKETS

Model	V	R
Max Capacity	4 x 150ml	
Angle	90°	
RPM Max	4 500	4 500
ACR Max	3 419	3 419

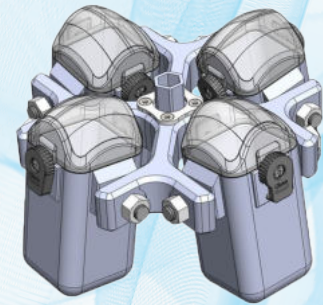

Accessories



Ref.	AFI-RXN150	AFI-B150*	AFI-L150*	AFI-SB150*	AFI-LSB150*	AFI-DB50*
------	------------	-----------	-----------	------------	-------------	-----------

* Set of 4

Tubes

Capacity (ml)	1,1-1,4	1,5-2	1,5-2	1,3	1,6-7	2,6-4,9	1,2-5	4-8,5	7-10	10
∅ x L (mm)	8x82	11x38	12,5x40	10x45	13x75 100	13x81 106	11x82 108	15x91 108	16x100	21x90
Tubes per adapter / rotor	9 36	18 72	9 36	9 36	9 36		9 36	6 24		4 16

Adapter

Hole ∅ x L (mm)	9x50	11,25x40	13x30	11x40	13,5x58		12,5x55	17x58		22x80
Radius	151	145	125	141	148		146	148		150
Max Charge (gr)	260									
Ref.	AFI-06T1-SB	AFI-06T2-SB	AFI-06T2CRYO-SB	AFI-06T1.3-SB	AFI-06T5-SB*		AFI-06T5ST-SB	AFI-06T10-SB		AFI-06T10C-SB

* For tube length > 80mm and ACR > 3000g, we preconise using adapter AFI-06T6-SB or AFI-06T6ST-SB

Tubes

Capacity (ml)	15	30	30	30	50	50	50	50	80 / 85	100
∅ x L (mm)	17x120	25x110	25x110	25x95	29x115	29x115	29x115	29x107	38x106	44x100
Tubes per adapter / rotor	2 8	1 4	1 4	1 4	1 4	1 4	1 4	1 4	1 4	1 4

Adapter

Hole ∅ x L (mm)	18x80	26x60	26x60	26,5x70	30x70	30x70	30x70	30x70	40x78	46x90
Radius	151	150	148	147	178	149	150	149	149	149
Max Charge (gr)	260									
Ref.	AFI-06T15C-SB	AFI-06T30S-SB	AFI-06T30C-SB	AFI-06T30AOR-SB	AFI-06T50S-SB	AFI-06T50CS-SB*	AFI-06T50C-SB	AFI-06T50AOR-SB	AFI-06T80AOR-SB	AFI-06T100-SB

* For protocols < 3500g

AFI RXN150 + DB50

Adapters selection guide

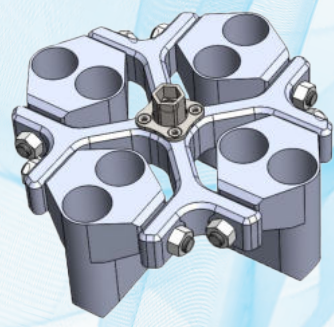

AFI-RXN150 + DB50

AFI-DB50 : CONICAL BUCKETS

Model	V	R
Max Capacity	4 x 150ml	
Angle	90°	
RPM Max	4 500	4 500
ACR Max	3 464	3 464

Accessories



Ref.	AFI-RXN150	AFI-B150*	AFI-L150*	AFI-SB150*	AFI-LSB150*	AFI-DB50*
	* Set of 4					

Tubes



Capacity (ml)	1,1-1,4	1,5-2	1,5-2	1,3	1,6-5	2,6-4	2,7-3	5-7	4,9	4,5-5	10
Ø x L (mm)	8x82	11x38	12,5x40	10x45	13x75	13x81 91	11x82	13x100	13x106	11x108	21x90
Tubes per adapter / rotor	3 24	3 24	3 24	3 24	1 8		3 24	1 8	1 8	1 8	1 8
Adapter											
Hole Ø x L (mm)	9x50	11,25x40	13x30	11x40	13,5x58		12,5x55	13,5x78	13,5x78	12,5x80	22x80
Radius	153	131	106	96	124		121	124	124	141	150
Max Charge (gr)	2x67										
Ref.	AFI-50R1-2	AFI-50R2-2	AFI-50R2CRYO-2	AFI-50R1.3-2	AFI-50R5-2		AFI-50R5ST-2	AFI-50R7-2	AFI-50R7-2	AFI-50R6ST-2	AFI-50R10C-2

Tubes



Capacity (ml)	4-8,5	7-10	10	15	30	30	30	50	50	50
Ø x L (mm)	15x91 108	16x100	16x85	17x120	25x110	25x110	25x95	29x115	29x115	29x107
Tubes per adapter / rotor	1 8		1 8	1 8	1 8	1 8	1 8	1 8	1 8	1 8
Adapter										
Hole Ø x L (mm)	17x78		17x70	18x80	26x60	26x60	26,5x70	30x70	30x70	30x70
Radius	153	134	134	152	134	140	143	134	152	142
Max Charge (gr)	2x67									
Ref.	AFI-50R10-2		AFI-50R10-OAK-2	AFI-50R15C-2	AFI-50R30S-2	AFI-50R30C-2	AFI-50R30-OAK-2	AFI-50R50S-2	-	AFI-50R50-OAK-2

MICROPLATES

Accessories selection guide



AFI-RBHDWN-150 : 8 MICROPLATES

Model	V	R
Max Capacity	-	-
Angle	90°	
RPM Max	4 500	4 500
ACR Max	2 400	2 400

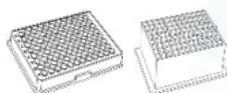
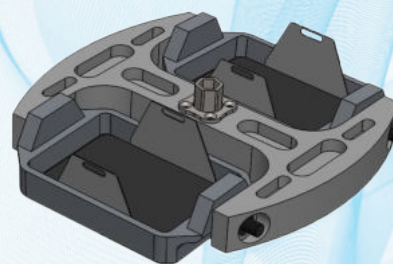

Microplates

	V	R		
Capacity (ml)	-	-	-	-
Max Height (mm)	-	-	55	55
Tubes per adapter / rotor	-	-	4 8	1 2

Accessories



	V	R	
Hole Ø x L(mm)	-	-	-
Radius	106	-	106
Max Charge (gr)	-	-	575
Ref.	AFI-RBHDW-N150	AFI-RHDW-N150	AFI-BHDW-N150*

* Set of 2

FIXED ANGULAR ROTOR

Accessories selection guide



ISA ACCESSORIES		AFI-RAN6-85	AFI-FAN6-50	AFI-RAN6-50	AFI-RAN12-15	AFI-RAN30-15
Max Capacity (ml)		6x85	6x50	6x50	12 tubes	30x 15
Max Speed (rpm)		6 700	6 700	5 600	6 700	4 500
Max RCF (g)		5 320	6 073	4 383	6 324	3 328
Lid			✓			
Acc/ Dec (sde)				140 90	110 100	
Tubes	ml	Ø x L				
	0,2-0,25		-	-	-	-
	0,5		-	-	-	-
	1,1-1,4	8x82	12	18	18	-
	1,5-2	11x38	24	18	18	-
	1,5-2	12,5x40	24	18	18	-
	1,6-5	13x75	12	6	6	12
	5-7	13x100	12	6	6	30
	2,6-4,9	13x81-106	112	6	6	-
	1,2-5	11x82-108	12	6	6	-
	5	16,5x60	-	-	-	-
	4-8,5	15x91-108	12	6	6	-
	10	16x100	12	6	6	12
	10 OAK	16x85	6	6	6	-
	10	21x90	6	6	6	-
	15	17x120	6	6	6	12
	30	25x110	6	6	6	-
	30	25x110	6	6	6	-
	30 OAK	25x95	6	6	6	-
	50	29x115	6	6	6	-
	50 OAK	29x107	6	6	6	-
	80 OAK 85 OAK	38x106	6	-	-	-
	94	38x102	6	-	-	-

Angular rotor 6x85ml - 28°

Model	V	R
Max Capacity	6 x 85ml	
Angle	28°	
RPM Max	6 700	6 700
ACR Max	5 320	5 320









Accessories











Ref.	AFI-RAN6-85
------	-------------

Tubes

Capacity (ml)	1,1-1,4	1,5-2	1,5-2	1,6-5	2,6-4	2,7-3	5-7	4,9	4,5-5	10
∅ x L (mm)	8x82	11x38	12,5x40	13x75	13x81 91	11x82	13x100	13x106	11x108	21x90
Tubes per adapter / rotor	2 12	4 24	4 24		2 12			2 12		1 6
Adapter										
Hole ∅ x L (mm)	9x50	11,25x40	13x30		13,5x58			13,5x78		22x80
Radius	106	87 103	83 104		87 103			87 103		95
Ref.	AFI-100R1-2	AFI-100R2-2	AFI-100R2CRYO-2		AFI-100R5-2			AFI-100R7-2		AFI-100R10C-2

Tubes

Capacity (ml)	4-8,5	7-10	10	15	30	30	30	50	50
∅ x L (mm)	15x91 108	16x100	16x85	17x120	25x110	25x110	25x95	29x115	29x107
Tubes per adapter / rotor	2 12		1 6	1 6	1 6	1 6	1 6	1 6	1 6
Adapter									
Hole ∅ x L (mm)	17x78		17x70	18x80	26x60	26x60	26,5x70	30x70	30x70
Radius	106		87 103	95	96	96	94	101	98
Ref.	AFI-100R10-2		AFI-100R10-OAK-2	AFI-100R15C-2	AFI-100R30S-2	AFI-100R30C-2	AFI-100R30-OAK-2	AFI-100R50C-2	AFI-100R50-OAK-

Tubes

Capacity (ml)	80	85	94
∅ x L (mm)	38x106	38x106	38x102
Tubes per adapter / rotor	1 6	1 6	1 6
Adapter			
Hole ∅ x L (mm)	39x86	39x86	39x86
Radius	106	106	106
Ref.	-	-	-

FIXED ANGULAR ROTOR

Accessories selection guide

Angular rotor 6x50ml - 40°

Model	V	R
Max Capacity	6 x 50ml	
Angle	40°	
RPM Max	5 600	5 600
ACR Max	4 383	4 383

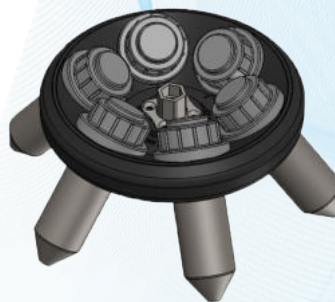

Accessories



Ref.	AFI-FAN6-50
------	-------------

Tubes

Capacity (ml)	1,1-1,4	1,5-2	1,5-2	1,3	1,6-5	2,6-4	2,7-3	5-7	4,9	4,5-5	10
∅ x L (mm)	8x82	11x38	12,5x40	10x45	13x75	13x81 91	11x82	13x100	13x106	11x108	21x90
Tubes per adapter / rotor	3 18	3 18	3 18	3 18	1 6		3 18	1 6	1 6	1 6	1 6

Adapter

Hole ∅ x L (mm)	9x50	11,25x40	13x30	11x40	13,5x58	12,5x55	13,5x78	13,5x78	12,5x80	22x80
Radius	106 120	97 111	96 108	94 105	110	105 116	118	118	118	118
Ref.	AFI-50R1-2	AFI-50R2-2	AFI-50R2CRYO-2	AFI-50R1.3ST-2	AFI-50R5-2	AFI-50R5ST-2	AFI-50R7-2	AFI-50R7-2	AFI-50R6ST-2	AFI-50R10C-2

Tubes

Capacity (ml)	4-8,5	7-10	10	15	30	30	30	50	50
∅ x L (mm)	15x91 108	16x100	16x85	17x120	25x110	25x110	25x95	29x115	29x107
Tubes per adapter / rotor	1 6		1 6	1 6	1 6	1 6	1 6	1 6	1 6

Adapter

Hole ∅ x L (mm)	17x78	17x70	18x80	26x60	26x60	26,5x70	30x70	30x70
Radius	118	108	120	122	118	121	125	#REF!
Ref.	AFI-50R10-2	AFI-50R10-OAK-	AFI-50R15C-2	AFI-50R30S-2	AFI-50R30C-2	AFI-50R30-OAK-	-	AFI-50R50-OAK-

Ideal for your sensitive samples.
 Sealed and individually removable adapters.
 Guaranteed safety throughout your analysis protocol, before, during and after centrifugation



Fixed rotor 6x50ml - 45° - Sealed

Model	V	R
Max Capacity	6x 50ml	
Angle	45	
RPM Max	6 700	6 700
ACR Max	6 073	6 073



Accessories



Ref.	AFI-RAN6-50
------	-------------



Tubes

Capacity (ml)	1,1-1,4	1,5-2	1,5-2	1,3	1,6-5	2,6-4	2,7-3	5-7	4,9	4,5-5	10
∅ x L (mm)	8x82	11x38	12,5x40	10x45	13x75	13x81 91	11x82	13x100	13x106	11x108	21x90
Tubes per adapter / rotor	3 18	3 18	3 18	3 18	1 6		3 18	1 6	1 6	1 6	1 6

Adapter

Hole ∅ x L (mm)	9x50	11,25x40	13x30	11x40	13,5x58	12,5x55	13,5x78	13,5x78	12,5x80	22x80
Radius	101 112	85 96	78 89	76 86	100	87 96	112	112	112	112
Ref.	AFI-50R1-2	AFI-50R2-2	AFI-50R2CRYO-2	AFI-50R1.3ST-2	AFI-50R5-2	AFI-50R5ST-2	AFI-50R7-2	AFI-50R7-2	AFI-50R6ST-2	AFI-50R10C-2



Tubes

Capacity (ml)	4-8,5	7-10	10	15	30	30	30	50	50
∅ x L (mm)	15x91 108	16x100	16x85	17x120	25x110	25x110	25x95	29x115	29x107
Tubes per adapter / rotor	1 6		1 6	1 6	1 6	1 6	1 6	1 6	1 6

Adapter

Hole ∅ x L (mm)	17x78	17x70	18x80	26x60	26x60	26,5x70	30x70	30x70
Radius	112	98	107	115	107	113	121	113
Ref.	AFI-50R10-2	AFI-50R10-OAK-2	AFI-50R15C-2	AFI-50R30S-2	AFI-50R30C-2	AFI-50R30-OAK-	-	AFI-50R50-OAK-

FIXED ANGULAR ROTOR





Accessories selection guide

Angular rotor 12 tubes

Model	V	R
Max Capacity	12 x 15ml	
Angle	37°	
RPM Max	6 700	6 700
ACR Max	6 324	6 324



Tubes

					
Capacity (ml)	-	1,6-5	10	14	15
∅ x L (mm)	-	13x75	16x100	17x100	17x120
Tubes per adapter / rotor	-	1 12	1 12	1 12	1 12

Accessories

					
Hole ∅ x L (mm)	18x98	13,5x78	17x78	18x98	18x98
Radius	103 126	89	103	103	109
Ref.	AFI-RAN12-15				

Angular rotor 30x15ml - 37°







Model	R
Max Capacity	30x 15mL
Angle	37°
RPM Max	4 500
ACR Max	3 328



Supplied with cups for cushioning your tubes



Tubes

							
Capacity (ml)	-	5	1,6-5	5-7	10	14	15
∅ x L (mm)	-	12x75	13x75	13x100	16x100	17x100	17x120
Tubes per adapter / rotor	-	1 30	1 30	1 30	1 30	1 30	1 30

Accessories

							
Hole ∅ x L (mm)	18x98	13,5x78	13,5x78	17x78	17x78	18x98	18x98
Radius	122 141	96 115	96 115	110 129	110 129	118 136	118 136
Ref.	AFI-RAN30-15						

AFI-CYTOLOGY PACK : ISA Ventilated + Cytology rotor

Model	V
Max Capacity	12 Funnels
Angle	90°
RPM Max	2 000
ACR Max	438

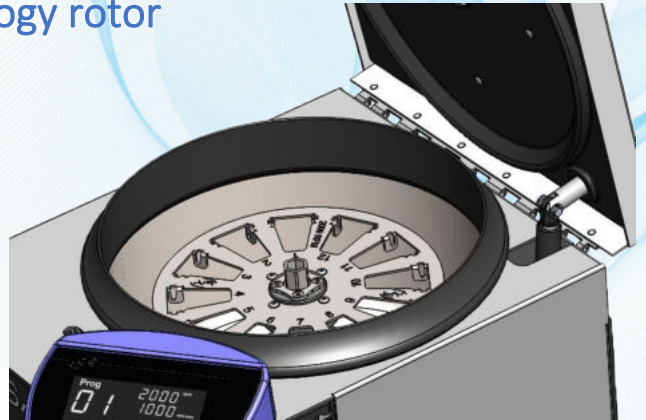

Accessories



Ref.	AFI-RCYTO-N150
------	----------------

EZ CYTOFUNNEL

PACKS	DOUBLE	DOUBLE	SINGLE	SINGLE	SINGLE
Capacity (mL)	0,5	0,5	0,5	0,5	0,5
Surface (mm ²)	28	28	28	28	28
∅ (mm)	6	6	6	6	6
Description					
Radius	98				
Set of	200	40	200	40	40
Ref.	AFI-EZ-DFWC-200	AFI-EZ DFWC-40	AFI-EZ-SFWC-200	AFI-EZ-SFWC-40	AFI-EZ-SFBC-40

INDIVIDUAL SOLUTIONS

	CLIP	CLIP
Description		
Radius	98	
Set of	6	50
Ref.	AFI-CLIP-M	AFI-CLIP-P



DOUBLE	DOUBLE	SINGLE	SINGLE	SINGLE
0,5	0,5	0,5	0,5	0,4
28	28	28	28	28
6	6	6	6	6
500	25	500	50	500
AFI-DFW-500	AFI-DFW-25	AFI-SFW-500	AFI-SFW50	AFI-SFB-50

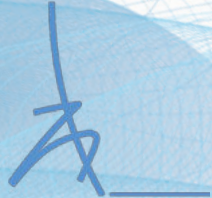

	SMALL	MEDIUM	LARGE
Ref.	AFI-MT550	AFI-MT750	AFI-MT850
Dimensions wxhxd (mm)	550x560x700	750x560x700	850x560x700
	2 tiroirs, 4 roulettes avec frein / 2 drawers, 4 wheels with brake		
LINA V	✓		
LINA R	✓		
ISA V	✓		
ISA R	✓		
SIRENA	✓		
LISA V	✓		
LISA R		✓	
LOREENA V		✓	
LOREENA R			✓

We offer you a range of AFI furniture dedicated to your centrifuges.

These furniture have been designed to last.
They are reinforced with a metal frame to ensure robustness.

They are equipped with 4 castors with brakes for more mobility and flexibility in your laboratory.

The large drawers allow you to place all your accessories.

These furniture are for you !



Notes

Lined area for notes, consisting of multiple horizontal red lines.



Spécifications - Specifications						
Modèle - Model	Ventilé - Ventilated		Réfrigéré - Refrigerating		Thermostaté/ Heating	
Centrifugeuse de paillasse Benchtop centrifuge						
Référence - Reference	AFI-CI060V-E	AFI-CI060V	AFI-CI060R-E	AFI-CI060R	AFI-CI060RH-E	AFI-CI060RH
Reference IVD/ IVD References*	AFI-CI060V-E/IVD	AFI-CI060V/IVD	AFI-CI060R-E/IVD	AFI-CI060R/IVD	AFI-CI060RH-E/IVD	AFI-CI060RH/IVD
Caractéristiques électriques - Electrical specifications						
Tension nominale - Nominal voltage (+/- 10%)	230 V	120 V	230 V	120 V	230V	120V
Fréquence - Frequency	50 / 60 Hz	60 Hz	50 Hz	60 Hz	50 / 60 Hz	60 Hz
Puissance alimentation max. - Power max.	400 W		800 W (460W compressor)		800 W (460W compressor)	
Conformité aux directives Européennes - Compliance with European directives						
(UE)2017/746 : Dispositifs médicaux de diagnostic in vitro - In vitro diagnostic medical devices *Only for IVD references	✓		✓		✓	
2014/35/UE : Directive Basse Tension – Low Voltage Directive	✓		✓		✓	
2014/30/UE : Directive CEM - EMC directive	✓		✓		✓	
2012/19/CE : Directive DEEE - WEEE directive	✓		✓		✓	
2011/65/CE : Directive ROHS - ROHS Directive	✓		✓		✓	
IEC / EN61010-1 (2010) : Sécurité - Safety	✓		✓		✓	
IEC / EN61010-2-020 (2006) : Sécurité - Safety	✓		✓		✓	
IEC / EN61010-2-101 (2015) : Sécurité - Safety	✓		✓		✓	
EN61326-1(2013) : Compatib. électromagn. - EMC compatibility	✓		✓		✓	
EN55011 2009/A1 (2010) Classe A : Perturbations / Emissions	✓		✓		✓	
EN ISO 14971 (2012) : Gestion des risques - Risk management	✓		✓		✓	
ISO 9001 (2015) : Gestion des risques - Risk management	✓		✓		✓	
ISO 13485 (2016) : Gestion des risques - Risk management	✓		✓		✓	
Caractéristiques principales (voir brochure) - Main specifications (see brochure for full specification)						
Rotors Swing-out <i>Swing-out rotors</i> 	Capacité max. Max. capacity	Rotor AFI-RXN-150 Bucket AFI-BX150	4 x 150 ml			
	RPM max.		4500 rpm			
	ACR max Max. RCF		3396 g			
Rotors Microplaques <i>Microplate rotors</i> 	Capacité max. Max. capacity	Rotor AFI-RHDWN-150 Bucket AFI-BXDW	2x3 microplaques 2x3 microplates			
	RPM max.		4500 rpm			
	ACR max Max. RCF		2400 g			
Rotors Angulaires <i>Fixed angle rotors</i> 	Capacité max. Max. capacity	Rotor AFI-RAN6-85	6 x 85 ml			
	RPM max.	Rotor AFI-RAN12-15	6700 rpm			
	ACR max Max. RCF		6324 g			
Couvercle - Lid			✓			
Dimensions & poids - Dimensions & Weight						
Dimensions (HxLxL) - Foot print Dimensions (HxWxD)	34 x 39 x 51 cm		34 x 46 x 72 cm		34 x 46 x 72 cm	
Profondeur table – Table deep	47 cm		65 cm		65 cm	
Dimensions emballage (HxLxL) - Package dimension	47 x 47 x 70 cm		47 x 52 x 81 cm		47 x 52 x 81 cm	
Hauteur couvercle ouvert - Opened lid height	74 cm		79 cm		79 cm	
Poids net - Weight unpacked	40 Kg		70 Kg		70 Kg	
Poids emballé - Weight packed	50 kg		80 kg		80 kg	

Description de la centrifugeuse / Centrifuge description

Référence - Reference	AFI-CI060V-E	AFI-CI060V	AFI-CI060R-E	AFI-CI060R	AFI-CI060RH-E	AFI-CI060RH
Écran LCD 4.7" 4.7" LCD screen				✓		
Commandes Commands				Molette + Touches tactiles Knob + Tactiles Buttons		
Contrôle par microprocesseur Microprocessor control				✓		
Reconnaissance automatique du rotor Automatic rotor recognition				✓		
Détection de balourd Imbalance detection			Calibration ajustable (15g swing out et 3g rotors angulaires). Neutralisation automatique des vibrations liées à l'environnement. Tunable calibration (15g for swing out & 3g for angular rotors). Automatic neutralization of vibrations due to environment			
Mode économie d'énergie Energy saving mode				Mode "Postcool" désactivable Desactivable "Postcool" mode		
Fermeture du couvercle Lid closing				Fermeture manuelle & ouverture motorisée Manual closing & motorized opening		
Durées de cycle Cycle duration				10 s à 99h:59min:59s & Impulsion 10 s to 99h:59min:59 s & Pulse		
Unités de température Temperature units				°C / °F		
Chambre de centrifugation Centrifugation chamber				Inox		
Densité max. Max. density				1.2 g / cm ³		
Moteur à induction sans charbon Brushless induction motor				✓		
Vitesse mini / Maxi Mini / Max Speed				300 / 6700 rpm		
Pas de réglage de la vitesse Speed setting step				50 ou 100 rpm suivant réglage utilisateur 50 or 100 according to user setting		
Précision de vitesse Speed accuracy				± 0.5%		
Nombre de programmes Programs number		99		99+2		
Fonction Pulse Pulse (short run)				✓		
Pentes d'accélération & de freinage Acceleration & Braking slopes				10 & 10		
Décélération libre Brakeless mode				✓		
Système de réfrigération Cooling system		Ventilation Ventilation device		Sans CFC CFC free		
Plage de réglage en température Range of setting temperature		N/A		-10°C → +40°C		
Echauffement (en C°) de l'échantillon à vitesse max pour T° ambiante 23°, Durée de fonctionnement en continu 45 mn. *performance optimale atteinte avec couvercle de nacelle Sample heating (C°) at max speed, 23° ambient temperature, Continuous operating time 45mn *optimum performance achieved with bucket lid		15		N/A		
Fonction de pré-refroidissement Precool function		N/A		✓		
Précision en température Temperature accuracy		N/A		+/- 2°C		
Dissipation de chaleur maximale Heat dissipation		1364 BTU/h		2729 BTU/h		
Niveau sonore max. Max. noise		≤ 56 dB(A)		≤ 54 dB(A)		

AUTOKLAVEN | SICHERHEITSWERKBÄNKE | CO₂-INKUBATOREN | ZENTRIFUGEN
ULTRATIEFKÜHLSCHRÄNKE | REINSTWASSERSYSTEME | TIERKÄFIGWECHSELSTATIONEN
ABWASSERSTERILISATION | SPÜLMASCHINEN | SERVICE, WARTUNG, VALIDIERUNG



ibs | tecnomara

Innovative Systeme für die Biotechnologie

Ruhberg 4 | 35463 Fernwald

Telefon: +49 64 04 80 9 - 0

Telefax: +49 64 04 80 9 - 251

info@tecnomara.de

www.tecnomara.de